

Instructions

Side View (Green)

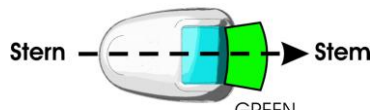

Parallel to the Horizont Side View (Red)

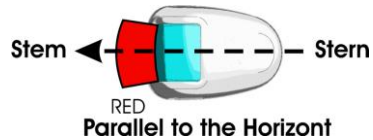

STEP1

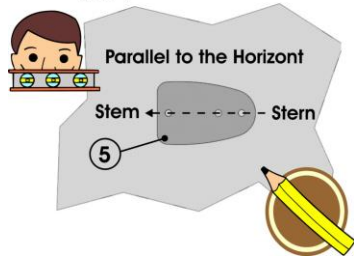

Use gasket (N°5) to locate the drilling holes on the craft

STEP2

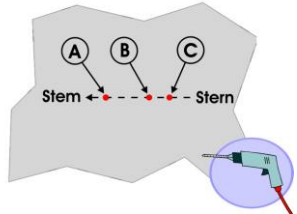

Make two holes ϕ 4mm (Position A and position C) and one hole ϕ 2,5 mm (position B)

Posizionamento

STEP3

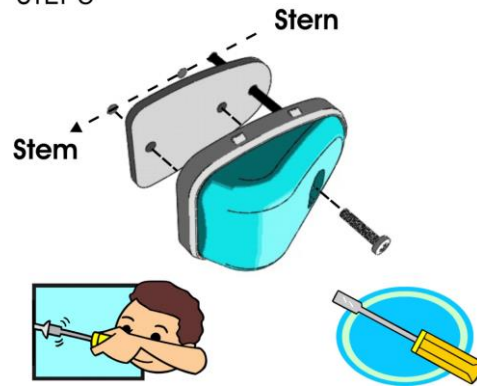

Position the basket, insert the cable, make the electric connection (brown cable to the positive terminal, blue cable to the negative terminal) and fix the light by the proper screw (N°2) supplied together with the assembly kit

STEP4

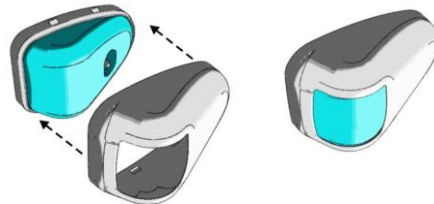

Finally, insert the screen (N°1).

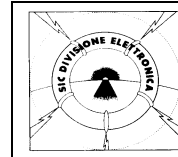

LED NAVIGATION LIGHTS

Orionis α side lights 112.5°

Side Lights for boats having length inferior or equal to 20mt
EPLF0002 GREEN
EPLF0003 RED

RINA TYPE APPROVAL CERTIFICATE No. ELE453105CS

INSTALLER'S OPERATING MANUAL

SIC DIVISIONE ELETTRONICA srl

WWW.SIC-DIVISIONE-ELETTRONICA.IT
LECCE - ITALY

Description:

Navigation lights for pleasure boats with length $L < 20$ metres and approved in accordance with international standards on prevention of collision in the sea **COLREG 1972**

Side Lights

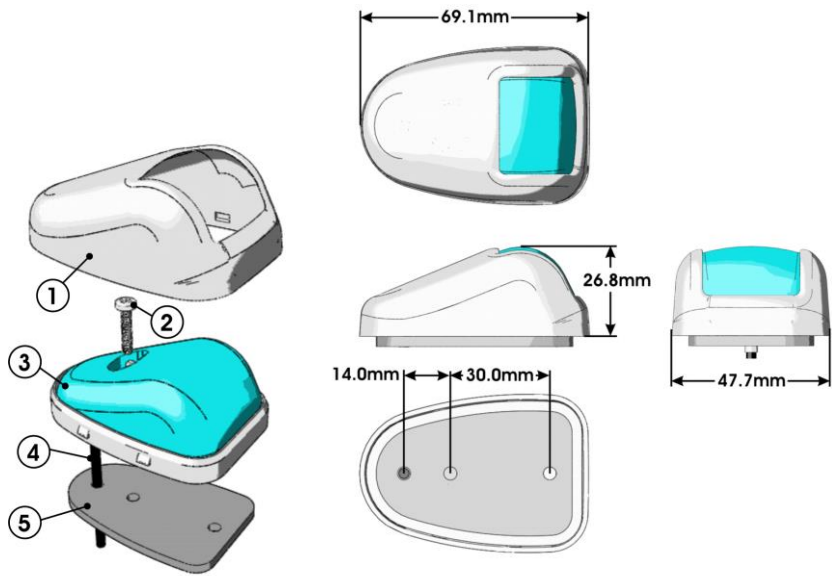

Positive (+) : Brown cable
Negative (-): Blue cable

Technical Characteristics

1. Screen made of polycarbonate o
 2. Screw 3X16
 3. Polycarbonate transparent dome
 4. supply cable 2x22AWG
 5. Gasket
- Field of application: boats < 20m
 - Visibility arc: 112.5°
 - Input voltage: 9-30Vcc
 - Luminous source: power red or green LED 1W
 - Protected against polarity inversion and spike
 - Equipped with supply cable
 - Maximum absorbed power: 2W
 - Impact resistant
 - Mechanical protection standard: IP56
 - Average life of the LED: 10.000 hours
 - Easy to install

Placement and installation of the Navigation Lights

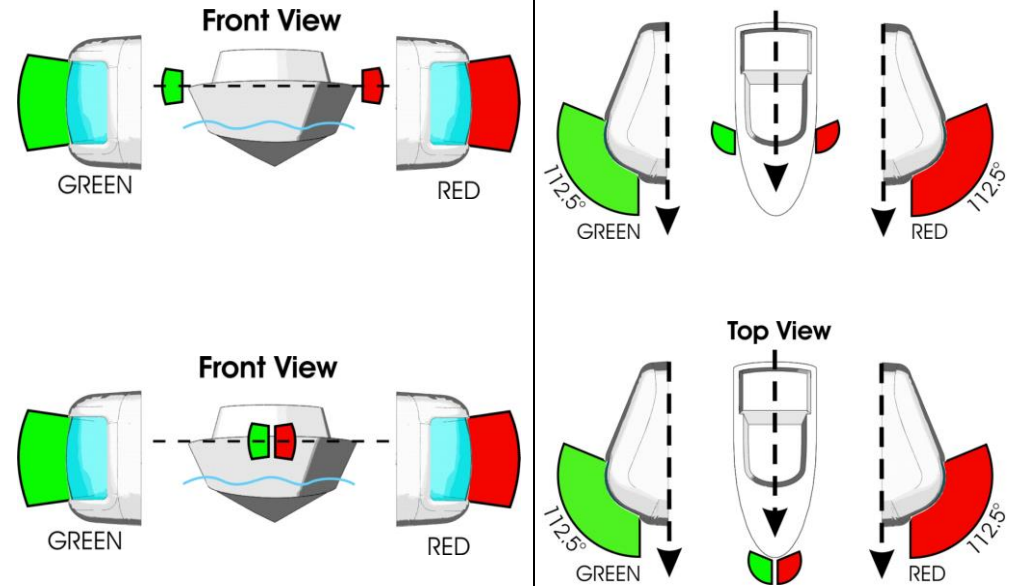

- The navigation lights shall be visible in the normal conditions of use.
- The navigation lights shall not be obscured by any fixed structures or by any optional equipment in the normal conditions of use.
- The navigation lights shall be installed in a way not to be a nuisance to the eyes of the operator.
- The navigation lights shall be installed in a way to ensure that the light appears in the required visibility arc and that is compliant with the required vertical separation and the placement requirements when the craft is in a static floating position

- The navigation lights shall be electrically connected to only one switch that operates all of the navigation lights together. Another switch used as a commutator shall switch on only the anchor light (360°).
- The navigation lights shall be assembled in a way to reduce to the minimum any damages caused by contacts with other objects in normal conditions of use